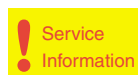

Service Service Service

QUADRA ACTION
Domestic Appliances and Personal Care

Service Manual

HINTS FOR REPAIRS

- Remove the shaving unit, to prevent damages during repairs.
- Remove screws A1 (2x, of which 1 is under trimmer slide).
- Take cover with trimmer from housing.
- Remove bracket (14 + 21).
- The PC-board can now be removed from the housing.
- Remove screws B1 (2x) the motor and hair-chamber can now be removed from the housing.
- Detach the motor clamping spings (item 17) on the bearing block with a small screwdriver.

GENERAL

- Mainsshaver possible.
- Converts input voltage 8-16V dc to constant Charge current (NiHH 1100mA, NiCD 680mA) or Constant motorvoltage at mainsshave. Start-up voltage min. 11V.
- Open battery protection.
- Undervoltage protection.
- Charge condition of battery is managed by Robin IC (custom IC). Charging time is determined by temperature (absolute or delta). Discharging time is determined by voltage level (BLI).
- Temperature (absolute or delta).
- Green LED for mains (input voltage present) and full (flashing). Red BLI LED (Battery Low Indication).
- Electronic on/off.

PRODUCTS MEETS THE REQUIREMENTS REGARDING INTERFERENCE SUPPRESION ON RADIO AND TELEVISION.

- AFTER THE PRODUCT HAS BEEN REPAIRED IT SHOULD FUNCTION PROPERLY AND HAS TO MEET THE SAFETY REQUIREMENTS AS LAID DOWN OFFICIALLY ESTABLISHED AT THIS MOMENT.

TECHNICAL DATA

Voltage	: 100-240 V 50/60Hz
Power consumption	: Motor depending
Motor voltage	: 2.4 V...
Power supply	: SMPS
Speed of cutters	: > 2100 r.p.m.
Shaving heads	: HQ6 - 4822 690 10214
Battery	: Green NiMH pack AA

SAP CODING: 8856 851 99999

CAUTION!

WHILE CHECKING THE P.C.-BOARD REMEMBER THAT MOST COMPONENTS AND MOTOR ARE ENERGIZED BY MAINS VOLTAGE.

PHILIPS

HQ 6851/A

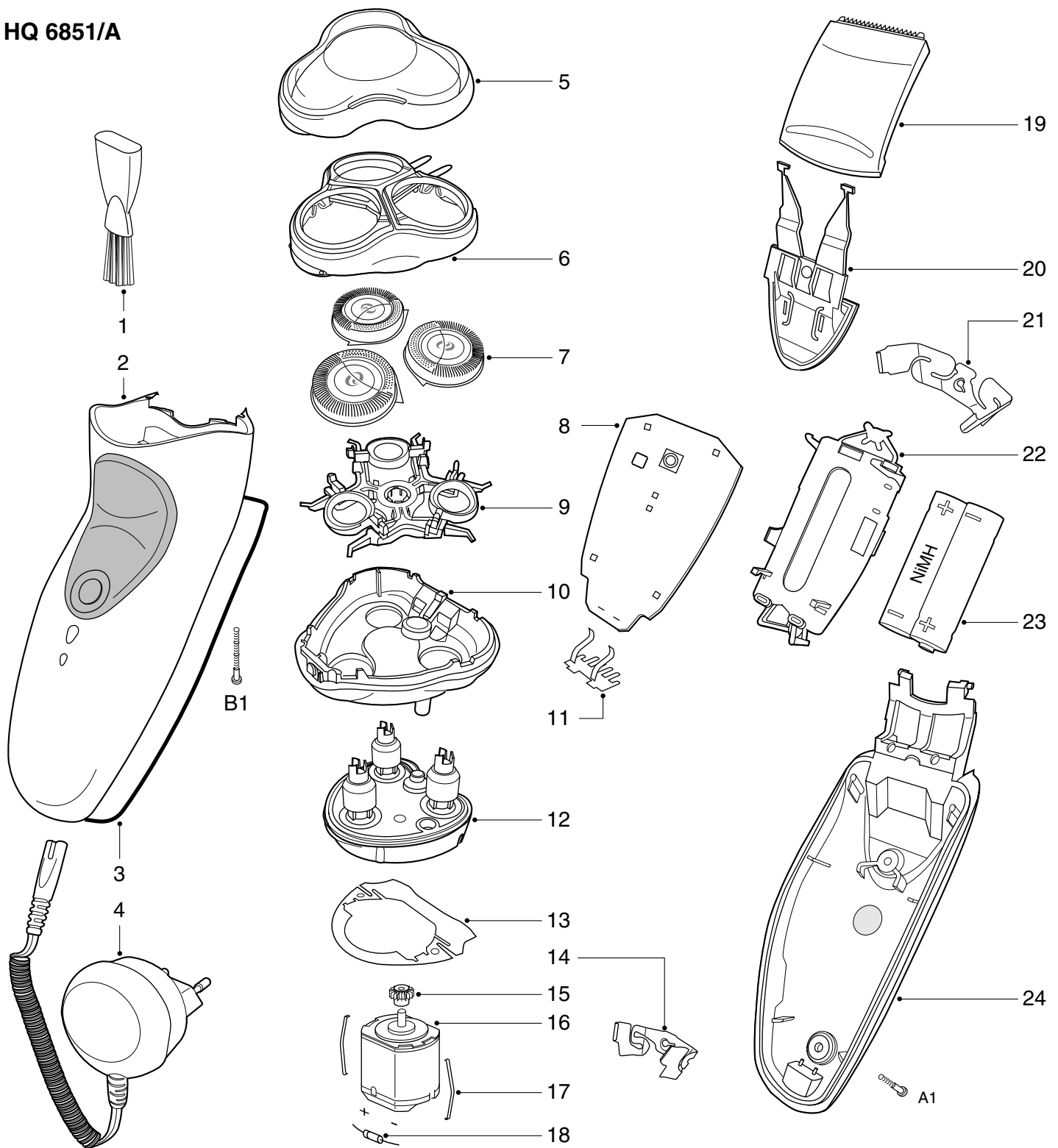

- 1 4822 479 20261 cleaning brush
- 2 4822 441 12348 housing PH
- 3 4822 466 12232 rubber seal
- 4 4822 219 10711 power plug EU
- 4822 219 10715 power plug GB

- 5 4822 462 11177 protecting cap
- 6 4822 441 12327 head housing
- 7 4822 690 10214 HQ6 shaving head
- 8 4822 214 13056 power module
- 9 4822 402 11319 retaining bracket

- 10 4822 442 01829 hairchamber PH
- 11 4822 265 11548 connecting pins
- 12 4822 522 10762 gearwheel unit
- 13 4822 466 12233 sealing plate
- 14 4822 402 11318 bracket small

- 15 4822 522 10763 pinion
- 16 4822 361 21783 motor
- 17 4822 492 71735 motor clamp
- 18 4822 130 34167 Zener diode
- 19 4822 690 10216 trimmer

- 20 4822 463 11258 trimmer slide
- 21 4822 402 11317 bracket large
- 22 4822 532 13149 spacer AA
- 23 4822 138 10728 NiMH pack AA
- 24 4822 442 01828 cover

- A 4822 502 14657 s.t.screw spec/T8
- B 4822 502 14544 s.t.screw 1.8x18/T8
- 4222 036 01090 pouch PH

4822 736 16918 DFU (1)

(1) GB D F N L E P I T R

* 4222 036 01960 Car cord

