



Philips Domestic Appliances and Personal Care

Service Manual

PRODUCT INFORMATION

General description:

The Philishave D-Finer is the first Precision shaper. A precision shaper is a specialized contouring appliance, created for men with specially shaped beards and sideburns. It gives ultimate control for defining precise lines and edges with unlimited styling possibilities.

Materials used:

- housing parts : ABS
- others : POM / steel / Nickel (Shaving foil)

Features:

- 15mm hi-definition trimmer
(Maintenance free cutting element: no oiling required)
- 17mm miniature foil
- Cleaning brush included

Safety

- This product meets the requirements regarding interference suppression on radio and TV.
- After the product has been repaired, it should function properly and has to meet the safety requirements as officially laid down at this moment.

TECHNICAL INFORMATION

- | | |
|---------------------------|----------------------------|
| - Power supply | : Rechargeable (RC) |
| primary (EU) | : 220 - 240 V - 50/60 Hz |
| secondary (EU) | : 1,6 V - 100 mA |
| primary (USA) | : 120 V - 60 Hz |
| secondary (USA) | : 1,6 V - 100 mA |
| - Charging time | : 10 h (NiCd & NiMh) |
| - Cordless operation time | : 40 minutes (NiCd & NiMh) |
| - Charging indication | : LED on adapter |
| - Dimensions Blister | : 16 x 9,4 x 24,7 cm |
| - Weight Blister | : 0,38 kg |
| - Weight product | : 104 g |

NOTES :

- In order to guarantee the longest possible workinglife of the battery:
 - do not charge for more than 24 hours
 - do not keep the charging unit permanently plugged in
 - discharge the battery completely once a year by letting the motor run until it stops
- If the battery is empty and the consumer wants to trim his beard, the trimmer has to be charged for at least 1.5 hours to have enough power for one trim
- The appliance should be charged again, when not used for a long period

For this Precision Shaper only the shown parts will be supplied:

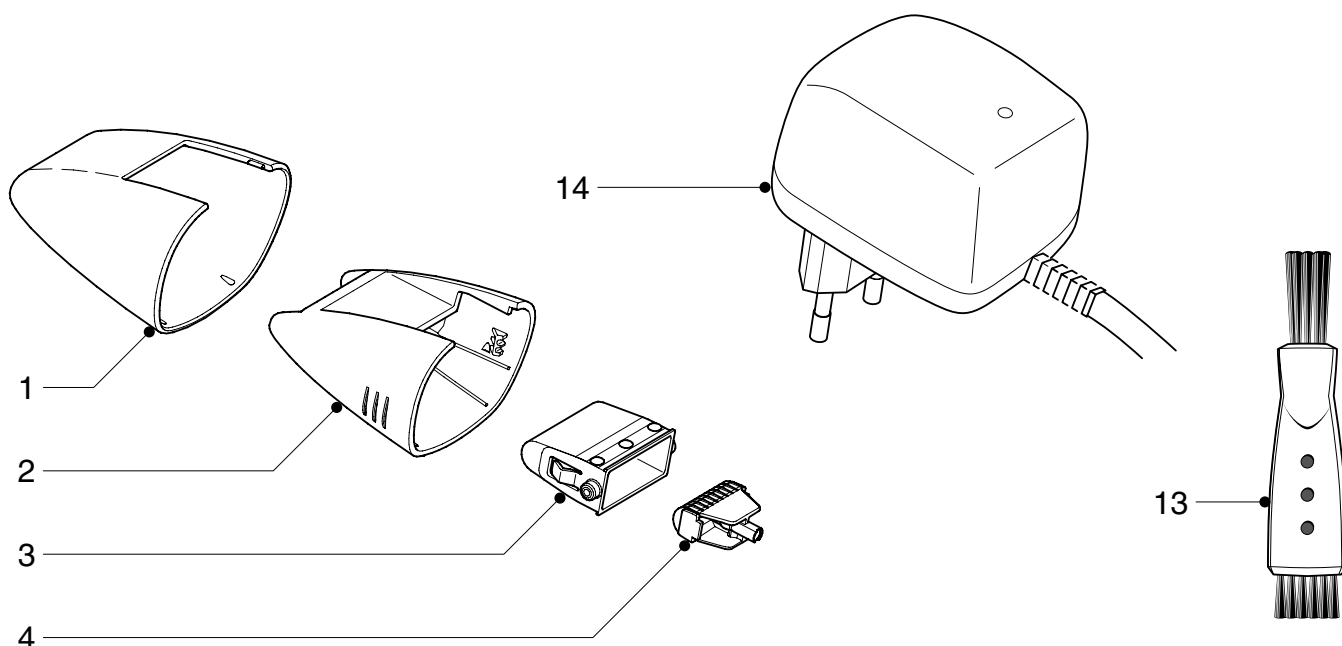

Pos	Service code	Description
1	4203 035 79200	Protecting cap
2	4203 035 79210	Foil housing
3	4203 035 79220	Shaving foil assy
4	4203 035 79230	Lamination cutter
13	4822 479 30183	Cleaning brush
14	4203 035 78390	Adapter - EU NiCd / NiMh
	4203 035 78400	Adapter - GB
	4203 035 78410	Adapter - CANADA
	4203 035 78420	Adapter - USA

HINTS FOR REPAIRS:

In case of complaints about a poor shaving quality and the absence of damages to the shaving unit, there is a possibility of the cutter stroke having become too small owing to pollution of the shaving head. A drop of thin oil on the foil and trimmers is likely to remedy this defect.

NOTE (only for USA) :

In the time between week 12 - 2003 and week 17 - 2003 (start of production), D350 appliances have been produced with a wrong typeplate text.

1.) The text on the typeplate of such an appliance tells you:

USE ONLY WITH DIRECT PLUG IN
TRANSFORMER 4203 035 78420

2.) The right text should be:

USE ONLY WITH DIRECT PLUG IN
TRANSFORMER 4203 030 77990

The typeplate text on the adapter is:

MODEL: 4203 030 77990

Be informed, that the adapter is the right one, only the 12NC at the typeplate is wrong on appliances, which were produced in the time between week 12 - 2003 and week 17 - 2003. From week 18 - 2003 onwards the typeplate of the appliance is corrected as shown in point 2.

DISASSEMBLY- AND RE-ASSEMBLY ADVISE

- To exchange the Shaving foil assy (3):

Push slightly, till the shaving foil assy (3) falls out of the foil housing (2).

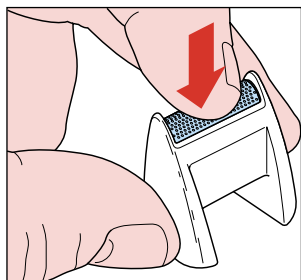

OPTIONAL (accessories)

- No specific issues