

Service
Service
Service



Philips Consumer Lifestyle

Service Manual

PRODUCT INFORMATION

General:

- Comb adapt to the contours of the face.
- 9 settings of the comb.
- Nose attachment.
- Charging indication. (LED on power plug)
- No oiling required.

Safety

- This product meets the requirements regarding interference suppression on radio and TV.
- After the product has been repaired, it should function properly and has to meet the safety requirements as officially laid down at this moment.

TECHNICAL INFORMATION

- Power system : Rechargeable
- Batteries : 1 x AA NiMh
- Charging period : 10 hours
- Capacity : up to 35 minutes
- SAP Coding : QG3030

DISASSEMBLY- AND RE-ASSEMBLY ADVISE

- No specific issues.

REPAIR INSTRUCTION

- No specific issues.

OPTIONAL (accessories)

- No specific issues.

NOTES :

- * In order to guarantee the longest possible working life of the battery :
 - do not charge for more than 24 hours
 - do not keep the charging unit permanently plugged in
 - discharge the battery completely once a year by letting the motor run until it stops
- * If the battery is empty and the consumer wants to trim his beard, the trimmer has to be charged for at least 3 hours to have enough power for one trim (10 min.)
- * The appliance should be charged again, when not used for a long period

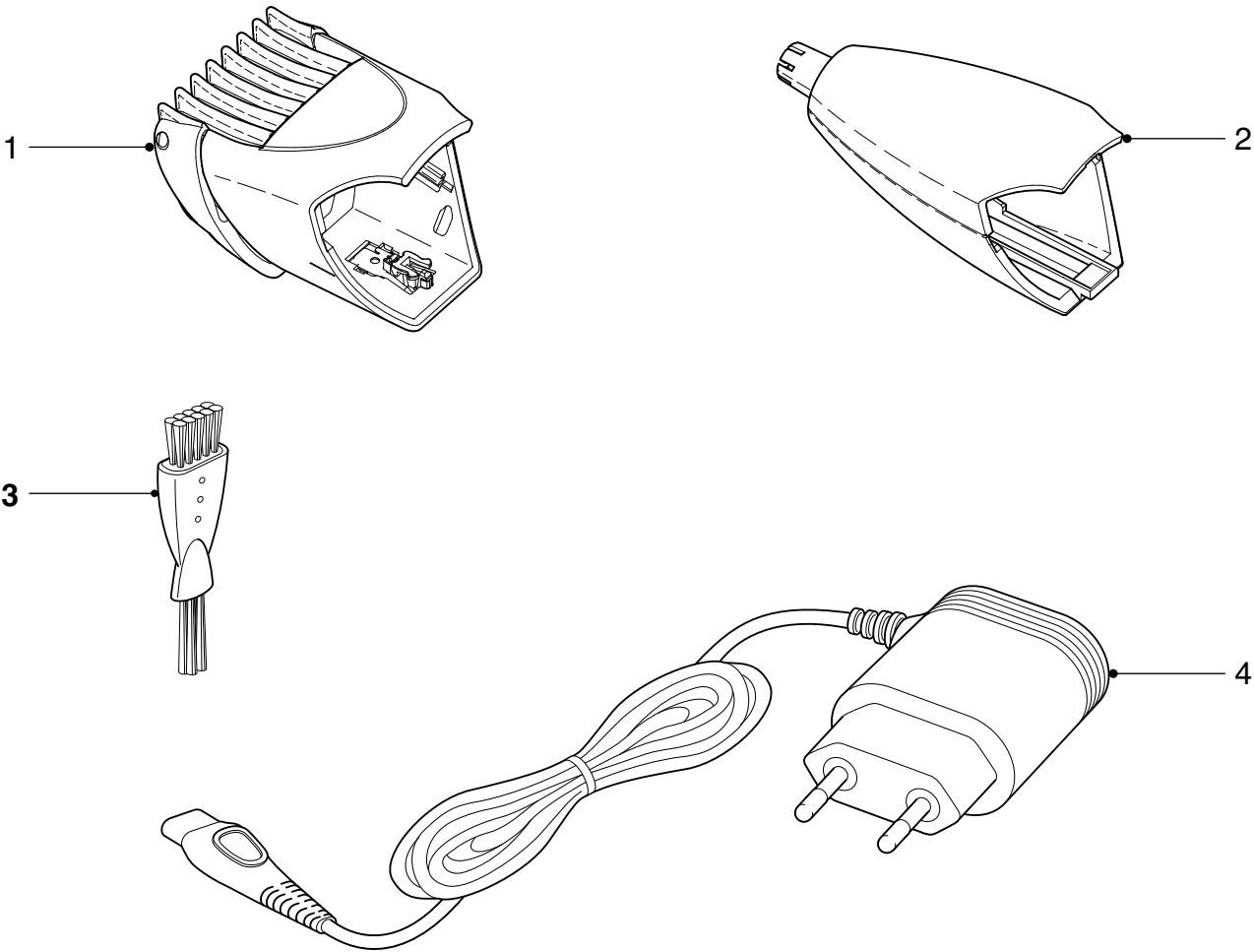

Pos	Service code	Description
1	4203 035 73080	Comb
2	4203 035 73120	Nose trimmer
3	4222 036 02770	Brush
4	4203 030 75011	Power plug Europa
	4203 030 75021	Power plug United Kingdom
	4203 030 75031	Power plug Australië/New Zealand
	4203 030 02841	Power plug Brasil
	4203 030 02211	Power plug Argentina